

LEGEND

450
Existing 1-1/2 Story Dwelling
1st Fl. Elev. = 7.8
TOF Elev. = 6.8

- TH 1 - Test hole
- TB - Test boring
- Spot Lamp
- Wooden Lamp
- Metal Lamp
- Concrete Lamp
- Utility Manhole
- Underground Utility Line
- Underground Electric Line
- Underground Electric Transformer
- Overhead Utilities
- Gas Line
- Sewer Service Line
- Sewer Main
- Septic Vent
- Septic Line
- Irrigation Line
- Monitoring Well
- Well
- Water Service
- Water Main
- Drainage Line
- Step
- Outdoor Shower
- Chimney
- Bay Window
- Window Well
- Foundation
- Deck
- Air Conditioning Unit
- Generator
- Interval Contour
- Index Contour
- Top of Slope
- Bottom of Slope
- Contour Label
- Brick Wall
- Concrete Wall
- Stone Wall
- Stone Wall
- Edge of Brush
- Coniferous Bush
- Deciduous Bush
- Edge of Garden
- Edge of Landscaping
- Edge of Lawn
- Coniferous Tree
- Deciduous Tree
- Treeline
- Chain Link Fence
- Guardrail
- Picket Fence
- Post and Rail Fence
- Stockade Fence
- Wire Fence
- Solid Fence
- Mailbox
- Concrete Bollard
- Metal Ballard
- Flag Pole
- Centerline
- Striping
- Edge of Asphalt
- Edge of Brick
- Edge of Concrete
- Asphalt Curb
- Concrete Curb
- Stone Curb
- Edge of Dirt
- Flowline
- Edge of Rock
- Edge of Shell
- Edge of Tile
- Edge of Stone
- Edge of Wood

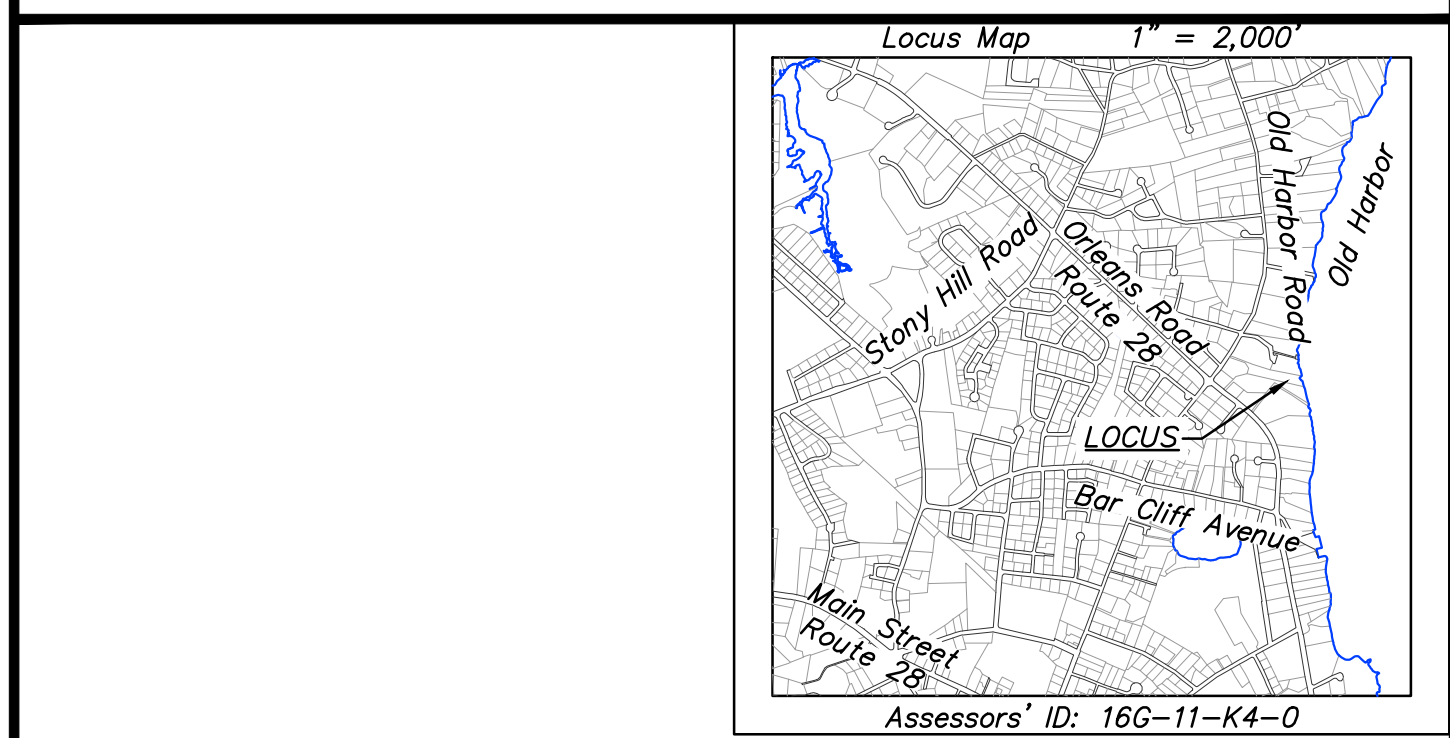

NOURISHMENT PLAN
450 Old harbor Road, Chatham, Massachusetts
February 25, 2019

OWNER OF RECORD:
Susan B. Morgan
Deed Book 26,926, Page 300
Plan Book 629, Page 69, Lot 4

| Description of Revision | Date |
|--|----------|
| Modified limits of nourishment, revised salt marsh | 04-05-19 |
| | |
| | |

SUSAN MORGAN

EAST-SOUTHEAST, LLC

www.ese-llc.com * office@ese-llc.com
1038 Main Street, Chatham, MA 02633
(508) 945-3965 * Fax: (508) 945-5885

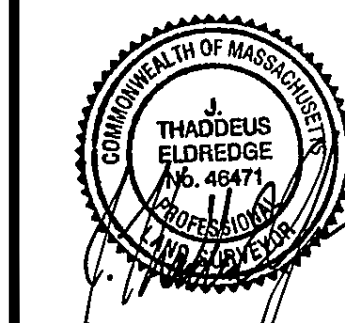

Vertical Datum: NAVD '88
Horizontal Datum: NAD '83 (2011)

