

CHECKLIST FOR SEWER SERVICE LATERAL INSTALLATION

Property Address: <u>139 VINEYARD AVENUE</u>	Street Served From: <u>VINEYARD AVENUE</u>
Date Work Completed: <u>DEC. 15TH, 2020</u>	Contractor: <u>C.C. CONSTRUCTION, INC</u>
Town: <u>CHATHAM</u>	Contract No. <u>2018-CWMP-2</u>
Sewer main diameter (nominal - inches): (circle one) <u>(8)</u> [10] [12] [Other]	Sewer lateral dia. (nominal - inches): (circle one) [4] <u>(6)</u> [8] [Other]
Connection to main sewer made with: (circle one) <u>(wye)</u> [tee] [saddle]	Lateral pipe material: (circle one) [DI] <u>(SDR 35)</u> [SDR 26] []
Chimney installed? (circle one) <u>(yes)</u> [no]	Approx. depth below finished grade at service lateral end: (measured to top/crown of pipe) <u>1 = 7.0'</u> feet
Approx. height of chimney: feet (measured from crown of pipe to top of chimney) <u>4.0'</u>	Date marking tape installed: <u>12.15.20</u> Approx. depth installed below grade <u>1.5'</u> feet
Distance from nearest downstream manhole: <u>8.0'</u> feet ;	Stake installed marking end of lateral: (circle one) <u>(yes)</u> [no] ; if no, reason: _____
Downstream manhole number: <u>SMH 579</u>	Date end cap installed: <u>12.15.20</u>

Location sketch

Show minimum of three referenced swing ties to permanent objects shown on Contract Drawings.
Show house and street outlines. Show North arrow.

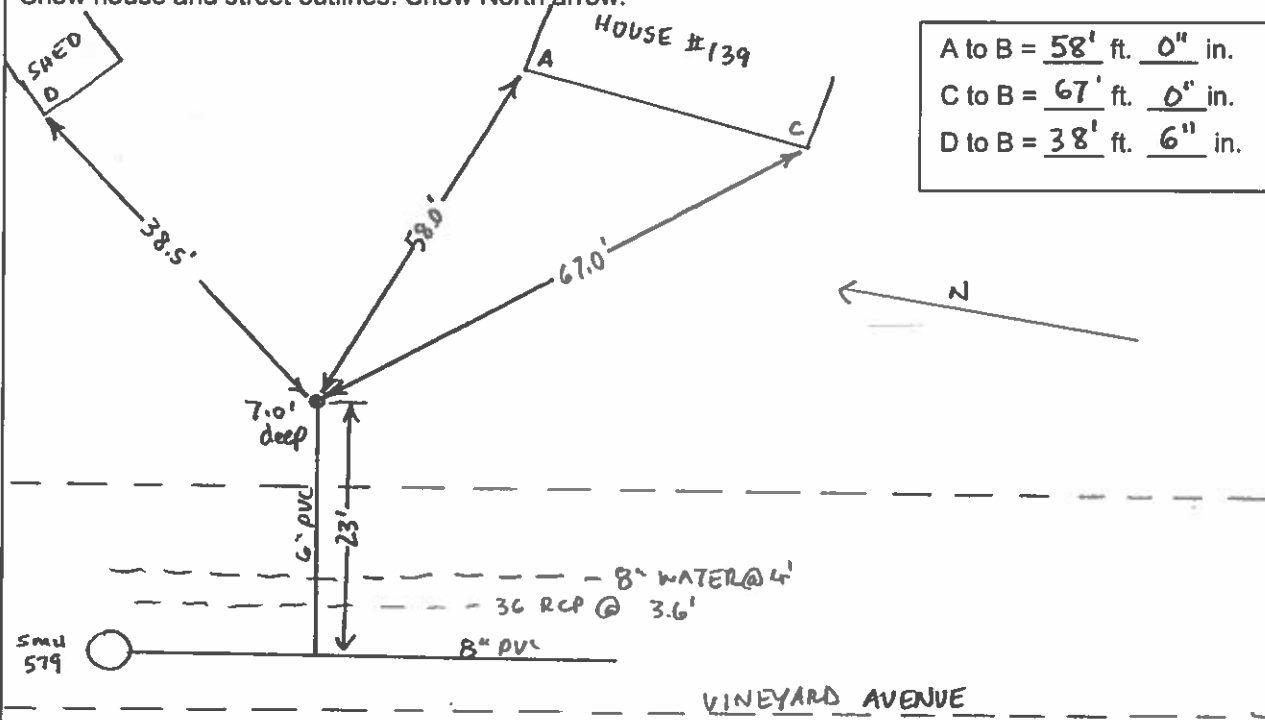

A to B = <u>58'</u> ft. <u>0"</u> in.
C to B = <u>67'</u> ft. <u>0"</u> in.
D to B = <u>38'</u> ft. <u>6"</u> in.

<u>David A Tel</u> <u>12-16-20</u> <small>(CONTRACTOR SIGNATURE AND DATE)</small>	<u>Kenneth Hodgson 2-4-21</u> <small>(RESIDENT PROJECT REPRESENTATIVE SIGNATURE AND DATE)</small>
<u>C.C. CONSTRUCTION, INC</u> <u>DAVID A. TELMAN</u> <small>(contractor name printed)</small>	<u>Kenneth Hodgson</u> <small>(resident project representative name printed)</small>
Contractor's Representative	Resident Project Representative

NOTE: The lateral locations are considered approximate and all horizontal and vertical dimensions shall be verified in the field prior to the commencement of any work related to the installation or connection of service laterals on private property.