

SITE PLAN

132 old Salt Works Road, Chatham, Massachusetts
 December 18, 2018
 OWNER OF RECORD:
 Hazel Wightman
 Certificate Number 204684
 Land Court Plan 7020-D, Lot 23
 Deed Book 28,443, page 131
 Plan Book 135, Page 21, Lot 23

Description of Revision	Date

BAYSIE WIGHTMAN
EAST-SOUTHEAST, LLC
 www.ese-llc.com * office@ese-llc.com
 1038 Main Street, Chatham, MA 02633
 (508) 945-3965 * Fax: (508) 945-5885

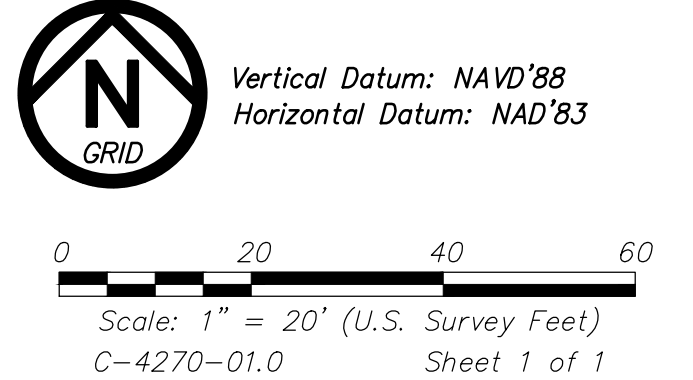
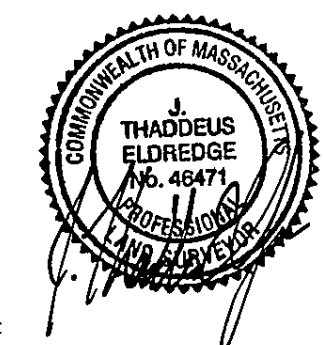

Within Resource Area / NDZ	Existing	Proposed	Net Change	Mitigation
Structures	2,871 S.F.±	2,871 S.F.±	0 S.F.±	0 S.F.±
Hardscape	2,970 S.F.±	3,114 S.F.±	144 S.F.±	288 S.F.±
Outer AURA				
Structures	0 S.F.±	0 S.F.±	0 S.F.±	0 S.F.±
Hardscape	0 S.F.±	0 S.F.±	0 S.F.±	0 S.F.±
Total	5,841 S.F.±	5,985 S.F.±	144 S.F.±	288 S.F.±

Planting List

Latin	Common	Status	Size	Spacing	Symbol	Quantity
Myrica pensylvanica	northern bayberry	FAC	3 gallon	4' o/c	Bay	3
Juniperus virginiana	eastern red cedar	FACU	4-6'	8-10' o/c	Cedar	1
	Native grass mix		seed			800 S.F.±