

**Orleans Road (State Highway) Route 28**  
 (40 Feet Wide) (Layout 1128)

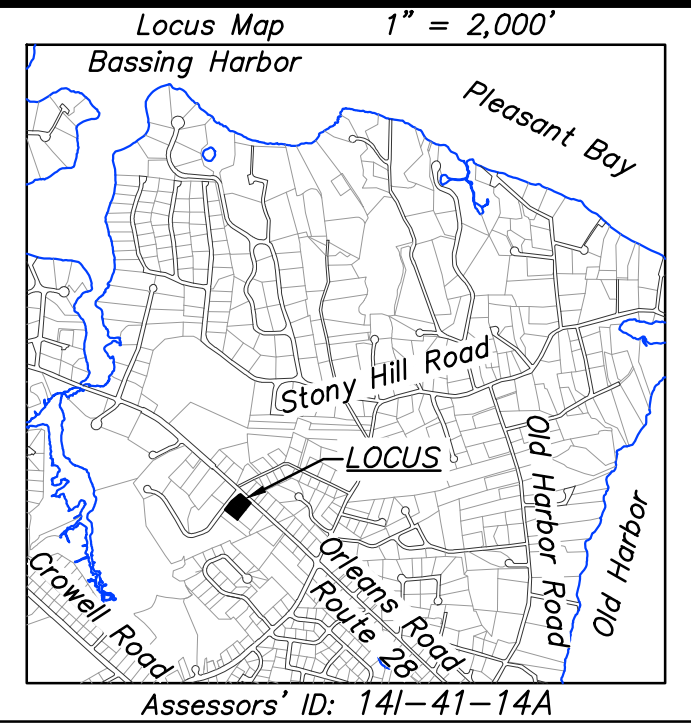
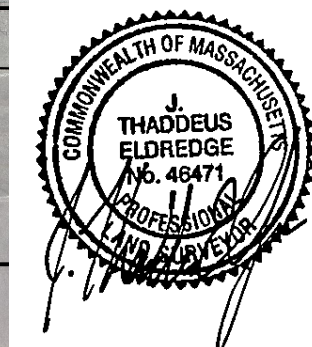

**BUILDING HEIGHT CALCULATION**

Building	Elevation				Average
NORTH	65.8 +	65.9 +	65.6 +	65.6 =	262.9 / 4 = 65.7
EAST	65.4 +	64.5 +	58.9	=	188.8 / 3 = 62.9
SOUTH	56.9 +	57.6 +	58.5	=	173.0 / 3 = 57.7
WEST	58.5 +	64.5 +	65.8	=	188.8 / 3 = 62.9
TOTAL					249.3
249.3 / 4 =					GRADE PLANE 62.3
62.3 + 30 =					MAXIMUM RIDGE ELEVATION 92.3
92.3 - Top of Foundation 66.2					26.1
<b>26.1 MAXIMUM HEIGHT ABOVE TOP OF FOUNDATION</b>					
92.3 - Ridge Elevation 93.9					-1.6
<b>EXISTING BUILDING HEIGHT</b>					<b>31.6</b>

Area = 34,582 S.F.±  
 or 0.794 Ac.±

**Misty Meadow Lane**  
 (40 Feet Wide) (Plan Book 366, Page 95)

I certify to Chatham Works Holdings, LLC and the Building Commissioner for the Town of Chatham, that, to the best of my knowledge and in my opinion, based on the Subdivision Plan of Land dated November 22, 1966 prepared by Nickerson & Berger, Surveyors, filed in the Land Registration Office as Land Court Plan 12310-G and the plan of record dated November 22, 1966 prepared by Nickerson & Berger - Engineers for Nanly Homes Inc. recorded in the Barnstable County Registry of Deeds as Plan Book 216, Page 105 and the concrete monuments (CB's) found, the building shown on this plan is located on the ground as shown hereon.

Date 08-8-19  
 L.S. [Signature]

**OWNER OF RECORD:**  
 Chatham Works Holdings, LLC  
 Deed Book 30,660, Page 151  
 Plan Book 216, Page 105, Lot 14  
 Certificate No. 213620  
 L.C. Plan 12,310-G, Lot 14

Description of Revision	Date
Updated with drone imagery	06-28-2019

**CHATHAM WORKS**  
**EAST-SOUTHEAST, LLC**  
 www.ese-llc.com ° office@ese-llc.com  
 1038 Main Street, Chatham, MA 02633  
 (508) 945-3965 ° Fax.: (508) 945-5885

