

CHECKLIST FOR LOW PRESSURE LATERAL INSTALLATION

- Field draft
- Final with signed field draft attached

Job No. CHATHAM Sewer Ph. 2
 Contract No. 2017-CWMP-1
 Contractor ROBERT B. OVR CO INC.

Date work completed 2-19-18

Street Absecon Run House No. 125
 Sewer Main Size 2" FUSION

ITEM		LOCATION SKETCH
1. Connection to Main Sewer		See BACK
(a) Made with used tee <u>COMPRESSION FIT</u>	✓	
(b) Made with cast iron saddle or plastic saddle	—	
(c) Encased with concrete	—	
2. Service Lateral Pipe Installed		
(a) Using PE pipe	✓	
(b) Using Schedule 40 PVC	—	
(c) Using PVC pipe <u>SDR 11</u>	—	
(d) Using plug at end of pipe	✓	
3. Following Backfill of Pipe		
(a) Stake set over end of lateral	✓	
(b) Stake marked to show depth of invert of pipe	✓	
4. Service Lateral Diameter (inches)	<u>1 1/4"</u>	
5. Approximate depth Below Grade to Invert at Service Lateral End (feet/inches)	<u>5'</u>	

CHECKED AND APPROVED

INSTRUCTIONS:

Complete every space accurately and sign in field.
 Show house and street outlines.
 Show a minimum of two referenced radius ties to permanent objects shown on Contract Drawings.
 Show station of wye fitting.

Ben Montez 2-19-18
 Contractor's Representative, date

R.B. Ovr 2/24/18
 Resident Project Representative, date

Copies for Owner, Field, and Office

END OF SECTION

A-C 52'10"

B-C 20'

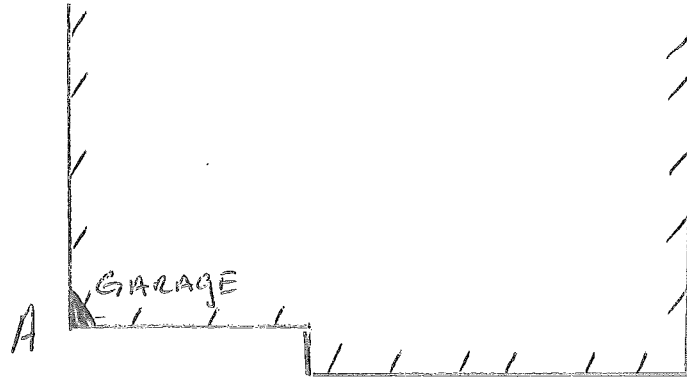

CATV
Utility Pedestal



A - C
- 16' LONG.

